

# Village of Schoolcraft

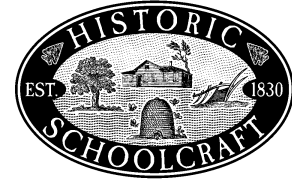

*Preserving our Past, Enriching our Present, Planning our Future*

www.villageofschoolcraft.com

## Village President's Message

Times Up ... You're on Deck!

If, you have been following the "Presidents Message" in your last few Newsletters, then you should not be surprised that now it's your time to speak!

After taking bids from three companies, the Village Council in open meetings interviewed two firms that do Visioning and Planning etc. An Ad Hoc Committee was chosen and studied the proposals and meeting results, then decided on **Wightman and Associates Inc.** to guide us through the proper steps.

Quite a lot of Schoolcraft High School "Football Fans" stopped at the booth at the homecoming game to share their opinions. Thank you, many good ideas on Businesses and Public Facilities that you mentioned were put on the "List of Wants" for the Village. This was one example of Community Ideas and Participation that will be valuable as we move forward.

By the time that you read this a "Steering Committee", consisting of; 3 members of the Village Council, 2 members of the Planning Commission and 2 members of the D.D.A. will be confirmed. That Base Committee will be moving forward to expand and include other Stake Holders and Business owners in our community. Soon there-after, the Village Residents and all Committees will be engaged in Public Workshops.

When you see notices for "Public Workshops", and/or "Public Meetings" regarding this Visioning Process, or people gathering information in various forums ... PLEASE! Take a minute to voice your opinion. We will sincerely be listening to your ideas and opinions as all of us can benefit from the end result.

If the Majority agrees on the types of Businesses, Public Spaces for Activities, and the Theme or Look of the Downtown, then our "Land Use Plan" can reflect those ideas and through Zoning Ordinances, we will be able to advocate growth of what the Majority wants to see in our Town. When the Town offers what most people want, then it will Flourish.

The Village Council has hired the professionals to guide us, the Village Staff and Committees are coming together with Community Businesses and Stakeholders ... the only element needed for success is YOU! Your opinions, ideas, and participation are needed to make our Town great again!

PLEASE, step up and participate, it will be to your benefit.

Keith Gunnett  
Schoolcraft Village President

### Vision Statement

The Village of Schoolcraft values its hometown character, in which the best elements of the Village's rich historical, cultural and natural heritage have been conserved and sensitively enhanced for the benefit of residents and visitors alike.

### Mission Statement

The Village of Schoolcraft will continually strive to maintain its friendly, unique hometown character, honoring its rich historical heritage. We will provide excellent, responsive services to our residential and business community. Development will be guided in such a way as to compliment the Village's vision and sense of place by encouraging resident, business, and community involvement.

## 2016 Quarterly Meeting Calendar

### Village Council 7:00 p.m.

October 3	October 17
November 7	November 21
December 5	December 19

### Planning Commission 7:00 p.m.

October 10	November 14
December 12	

### Downtown Development Authority 8:00 a.m.

October 6	November 3
December 1	

All meetings are open to the public and are held at the Municipal Complex at 442. N. Grand Street

## News from the Village Manager's Desk

Hello and Happy Fall! Summer is over, and now it is time for some fun fall activities like watching our Schoolcraft Eagles Football games, enjoying the beautiful fall colors, and raking leaves!

It has been a busy summer for the Village, and much work will happen during the next few months. Road and sidewalk projects for 2017 will be identified. The Village will embark on a Citizen and Village Mission Statement; identifying needs and wants for our community, then update the Village's Comprehensive Land Use Plan, and finally, reviewing and modifying our current zoning ordinances to allow changes to occur in our community. This will be based on the input we receive in the next few weeks and months as we create a plan and a strategy for funding new improvements and projects.

Our committees will be very busy in the next few months as they work with Wightman & Associates to create a Citizen and Village Mission Statement, and seek new ways to redevelop the US 131 Business Corridor. Work has already started with the identification of a number of things our residents both young and old would like to see in the Village. Some of those things range from more restaurants, to more things for the younger generation including sports centers, walking trails, community pools, and more. All of these ideas are great and we are excited to begin the process of revitalizing our village! Many opportunities will come for citizen input and we hope and encourage you to participate in community forums and meetings.

The last brush pick up date is October 31st. Leaf pick begins the last week in October and ends the week of Thanksgiving. Refer to page 3 for guidelines on both brush pick and leaf pick up.

The fall season also begins the budgeting process for the Village. Many hours and much work is involved in putting together a balanced budget, and it is especially challenging with reduced revenue sharing and the loss of personal property taxes. Still, we are happy to say that we are able to continue providing the same services to you year after year including spring clean up, new and replacement sidewalks, bi-annual road projects, and much more.

For information regarding the Village of Schoolcraft, please visit our web page at [www.villageofschoolcraft.com](http://www.villageofschoolcraft.com) or like us on Facebook or better yet, stop in the office and see us. We are happy to answer any questions and concerns you may have.

On behalf of the Village of Schoolcraft, we wish you a safe and happy fall season!

Cheri M. Lutz  
Village Manager  
[cmlutz@villageofschoolcraft.com](mailto:cmlutz@villageofschoolcraft.com)



## Schoolcraft Police Department

### Disposing Old or Unused Medication

Did you know prescription medications are one of the most sought-after items by burglars. The solution is to get rid of them. Flushing medication down the toilet or a drain leads to pollution in the ground water and the Great Lakes, causing adverse effects on drinking water and wildlife. Medication disposed of in the garbage ends up in a landfill, causing similar environmental impacts or risk of it landing in the wrong hands.

It is recommended disposing of old and unwanted medications at a Red Med Box; one of which is located at the Municipal complex at 442 N. Grand St., Schoolcraft. The box is a secure receptacle and is available 8:00-4:00 p.m. Monday thru Friday. Simply cross out the patient's name with a black marker (NOT the name of the medication) and drop the medication in it's original packaging in the Red Med Box.

Red Med Box will accept:

- Expired and unused medications
- Over the counter medications
- Antibiotics/steroids
- Cold and flu medications
- Vitamins and herbal supplements
- Medications samples
- Pet Medications
- Medicated Ointment/lotion/drops
- Unopened Epi-Pens
- Liquid Medications

Items not accepted by Red Med Box are:

- Needles/lancets/syringes
- Thermometers
- IV bags
- Bloody or infectious waste
- Hydrogen peroxide, rubbing alcohol, etc.
- Business waste
- Empty containers
- Personal care products
- Used Epi-Pens
- Aerosol cans
- Electronic devices (diabetes testers, etc.)
- Inhalants

For more information visit [redmedbox.com](http://redmedbox.com).

Chief Bryan Campbell  
[bcampbell@villageofschoolcraft.com](mailto:bcampbell@villageofschoolcraft.com)

## Fire Hydrant Flushing October 11, 2016

Be sure to run your water before doing laundry to prevent yellowing.

### Leaf Pick Up

Leaf pick up begins the last week of October and ends the week of Thanksgiving.

- Only leaves will be picked up. Please keep debris out of leaf piles.
- Do not combine leaves with sticks, root balls, trash or stones.
- Piles of leaves should be within 6 ft. of the edge of the street, but not in the street.

### Brush Pick-Up

The last day for brush pick-up is Monday, October 31, 2016. Please use the following guidelines when putting your brush at the road:

- **Brush may be taken to the right of way no sooner than the Wednesday before the pick up day.**
- **Brush must be out to the curb by 7:00 a.m. on pick up day.**
- Brush should be less than four inches (4") in diameter and 8' in length.
- All cut ends of brush should be placed in the same direction, toward the road.
- Brush piles should be placed between the street and sidewalk when possible.
- **Brush piles should be no larger than can be picked up by any one person.** If you have multiple piles, spread them out with space in between along your property.
- Brush piles should not be tied together with any material.
- Small sticks and twigs must be put into a container that can be emptied by one person
- Unacceptable material include leaves, yard waste (gasses, weeds, plants or vines), root balls, dirt, building materials and any brush generated through a removal of a tree, bushes or hedgerow.
- **Brush placed out in violation of the restrictions will not be picked up.**
- There is a limit of one dump truck load per month, per house.

The Village of Schoolcraft does appreciate your cooperation.

## Winter Streets and Sidewalks

During the snow season, we ask for your patience and cooperation regarding snow removal. It is our goal to remove it as quickly and safely as possible.

Our first priority is to open major and local streets. This can be accomplished more efficiently if vehicles are not parked along the street. When possible, please be sure to park off the street during the winter months.

Once the snow has been removed from the streets, the DPW will remove the sidewalks of snow. Be sure your vehicles are not blocking the sidewalks. Village residents who have placed decorative fences along the public sidewalks may wish to remove them during the winter months to avoid any damage that may occur during the snow removal season.

## Snow Removal

State and Local Ordinance prohibits the plowing of snow into or across sidewalks and streets if it leaves snow or slush on the roadway. This ordinance is for vehicular and pedestrian safety.

Please be sure that when you are cleaning snow from your driveway you are also keeping it off the sidewalks and roadway.

Your cooperation will be greatly appreciated by our winter walkers.

## Curfew

Any person 16 years of age or younger may not be out between the hours of 10 p.m. and 6 a.m. There are some exceptions. The curfew ordinance is meant to curb juveniles from being out in public in the Village during the before mentioned times.

**Village of Schoolcraft  
Trick or Treat  
5:30-8:30 p.m.  
October 31, 2016**

## Office Closures

The Village Office will be closed on the following Dates:

November 24, 2016  
November 25, 2016  
December 23—26 & December 30, 2016  
January 2, 2017

## South County Community Services



Diane Durian is the newest member of the SCCS team of providers. She is pictured here with Drew Johnson, SCCS Emergency Assistance Coordinator and Director Danna Downing. Diane is a critical component of the AGING WELL IN SOUTH COUNTY campaign made possible in large part by the Vicksburg United Way.

### **Ageing well in South County: SCCS Initiative to Address Community Needs.**

#### South County Community Services (SCCS) Invites you to Consider these Facts:

1. According to recent US Census data, there are 3,054 seniors (65+) who live in the SCCS service area. It is estimated that 1,032 of those people live in poverty and many more seniors find it difficult, if not impossible to meet all their basic needs on a regular basis.
2. Seven hundred and eighteen (718) of those people are living alone.
3. Nine percent (339) of SCCS seniors are experiencing hunger and poor nutrition.
4. SCCS is currently reaching only about 50% of South County with the agency's food pantry, dining vouchers and commodities available from Senior Services.
5. A significant number of South County seniors are at risk from fraud and elder abuse.
6. According to the Michigan Department of Transportation (MDOT), safe mobility in rural areas needs to be better understood and the transportation needs of seniors addressed in a more pro-active manner. The safety and well-being of seniors depends heavily on their ability to access needed services in a reliable and timely way. Better transportation opportunities are a critical need in South County.
7. Judy Sivak, the director of the local Area Agency on Aging, maintains that the greatest need for the South County service area is for seniors and their caregivers to be able to build a menu of supportive resources and relationships to help them age well and safely stay in their community as long as possible.

With support from the Vicksburg United Way, SCCS has hired a part-time Senior Outreach Coordinator. Meet Diane Durian—

no stranger to South County. She is known and appreciated as the social worker serving the residents at Cedar Park Senior Apartments in Schoolcraft. In her additional new role at SCCS her first priority will be to interview a significant number of seniors and caregivers in order to identify and prioritize their needs and wishes. She will also be using many of the skills and relationships she developed at Cedar Park Senior Apartments to help families all across the SCCS service area which includes the townships of Prairie Ronde, Schoolcraft, Brady, Wakeshma, Climax, and Pavillion.

Diane Durian will be joining a team of other helpers from SCCS who are making it a priority to assist older adults and their families to:

- Know what supportive services are available.
- Know how to use the services.
- Partner successfully with persons and programs that help them manage physical, emotional and financial barriers they face.

Community volunteers will be visiting area neighborhoods going door-to-door in September and October to let residents know how they can become involved in the AGING WELL IN SOUTH COUNTY campaign. The first team of volunteers starts on October 8 and 9. Information will also be shared with other community organizations and groups. If you have questions or would like to assist, please call Danna Downing, Director of South County Community Services at 269-649-2901.



DPW Superintendent Rob Coffman accepts a check from the Department of Community Health for a Fluoridation Equipment Award in the amount of \$4,850.00. Funds will be used to maintain the Village's Water Fluoridation Equipment including chemical feed pumps, and lab testing equipment.



## FALL PROGRAMING AT THE SCHOOLCRAFT COMMUNITY LIBRARY

**TOT TIME**-- Tuesdays—9:30-10:30 a.m.--- For toddlers 18-36 months and one adult for a lapsit program. (mom, grandma, babysitter etc.) Includes rhymes, finger plays, songs, books and optional free play. No registration required. Come when you can!

**PRESCHOOL STORY HOUR**-- Thursdays—10:00-10:45 a.m.---Ages 3-5 years. Come join us for a fun-filled morning of stories, finger plays, movement, music, crafts and snack. Please register for this program.

**FALL SPOOKTACULAR**---October 25—6 p.m.--We are celebrating autumn with an evening of comedy, magic and trick-or-treat in the library! Join us to see Joel's Spooktacular Comedy Show, an exciting-not-scary show that celebrates the spirit of the season and is appropriate for kids and grownups. Following the 45 minute show, there will be trick-or-treating in the library, so be sure to come in costume! All ages program.

**TEEN BOOK CLUB**---For grades 6-9<sup>th</sup> --We are kicking off fall with a special meeting on Monday, October 3 from 6-7 p.m. Participants will receive the first book choice, play some ice breakers and have snacks. Sign up for teen book club by calling the library and asking for Miss Pam.

**BATTLE OF BOOKS—22<sup>nd</sup> Year**—The 22<sup>nd</sup> annual Battle of the Books is gearing up for 2016-2017. The booklist will be released on **Friday, October 21** and Team Registration forms are due **November 18**. For the adults, the Coaches Meeting is on **November 7** at the Schoolcraft Community Library at 7 p.m. Bring your Coaches Packet with you.

**ADULT BOOK CLUB**---October 5—2-3 p.m.—The Prairie Page Turners have been reading books with Red, White and Blue in the title to lead up to the election. Octobers selection is books of their own choosing with the word "Blue" in the title. Refreshments served. New members encouraged to join this lively group.

**ART ON DISPLAY--QUILTS**—Through mid October ---Come see our fall quilt display featuring beautiful antique and modern quilts crafted by Kirk and Kelly Bergland and AnJie Havens. Over 30 quilts on display!

**ORPHAN TRAIN**—November 9-- Come join us at the Library to learn about the Orphan Train in Michigan. Al and David Eicher will present lecture and video segments about this fascinating event in Michigan's history. On **November 9th at 6:00 pm** these historians will discuss the 12,500 Orphan Train Riders that were placed in Michigan from 1854 to 1927. Free event open to the public.

**OSHER LIFELONG LEARNING AT THE SCHOOLCRAFT LIBRARY:** The Schoolcraft Library is excited to again partner with the Osher Lifelong Learning Institute at WMU for the fall session. Classes will be held in the Robert Crissman Community Room at a minimal cost through the program.

**Creativity with Paper:** 10/3, 10/10, 10/17 1-3p.m. (Please note there is a materials fee for this course.)

**Greek & Roman Coins: Their Beauty and Message 2700 Years Later**—10/17 & 10/24 9-11a.m.

**Registration: Members may register online at [wmich.edu/olli](http://wmich.edu/olli), by phone with a credit card at (269) 387-4200, or in person by going to room #3202, on the third floor of Ellsworth Hall on the WMU campus.**

\*\*\*\*\*

**TOURNAMENT OF WRITERS 2016:** The writer's contest is back! Entries for the competition accepted until **Friday, October 14**. Offering five age divisions this year with three categories. Awards will include Grand Prize, 1st, 2nd, 3rd prizes for each age division and category. Winning entries will be published in a book which will be available at the library. This competition is sponsored by Books for Dessert and the Schoolcraft Friends of the Library. Must be a Schoolcraft Community Library card holder to enter. Learn more at [booksfordessert.com](http://booksfordessert.com).

**HISTORICAL HOMES FOR THE HOLIDAYS TOUR**---The Friends of the Library are holding a fundraiser featuring a festive evening of historic homes, light meal and dessert. Tour four historic homes decorated for the holidays as well as the Ladies Library of Schoolcraft who will be serving dessert, and make a stop in the Schoolcraft Community Library for soup & bread. **December 10<sup>th</sup> from 4-8 p.m. Cost is \$25/ ticket; available in the library and online starting Oct 1<sup>st</sup>.**

**SCHOOLCRAFT COMMUNITY LIBRARY: 330 N. CENTRE STREET SCHOOLCRAFT, MI 49087 : (269) 679-5959**





# **FREE Electronics Recycling**

## **Saturday October 8, 2016 9am-12pm**

### **Schoolcraft Township Hall**

#### **Items accepted include:**

**Computers, cell phones, flat screen monitors, printers, mice, keyboards, cords, cables, modems, WIFI routers, cameras, DVD and VCR players, iPods, PDAs, gaming consoles and accessories, CD players, radios, stereos, microwaves, calculators, cameras, remote controls, UPS, and most other electronic items.**

**CRT monitors - \$15 fee.**

**No televisions, smoke detectors, dehumidifiers or large appliances please!**

**Event location: Schoolcraft Township Hall**  
**50 East VW Ave Vicksburg, MI**

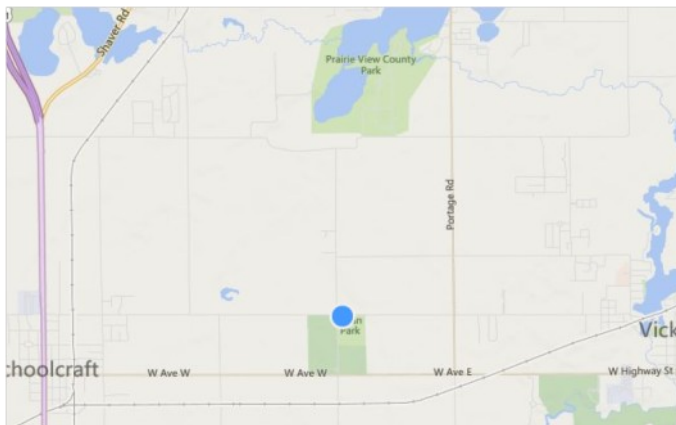

**Sensitive information on your computer hard drive? Hard drive shredding is available for a \$10 fee.**

**Questions about items accepted? Call Emerald at 269-978-1914.**

**For more information, contact Emerald eCycling LLC @ 269-978-1914**  
**or check our website @ [www.emerald-ecycling.com](http://www.emerald-ecycling.com)**

## **IMPORTANT NOTICE**

**US 131 will be closed for road repair at the RR tracks and South St. in Schoolcraft.**

**The highway will be completely closed beginning Saturday, October 22 through Saturday, November 5.**

**South bound traffic will be detoured at Eliza St. east to 14th St. South and west on XY Ave. North bound traffic will be detoured along the same route.**

### **Elect Village Council!!**

November 8, 2016 - General Election  
7:00 am- 8:00 pm  
Ken Krum Center -519 E. Clay St.

### **Have you registered to vote?**

The last day for new registrations is Tuesday, October 11th. Please see Clerk Virginia Mongreig at Schoolcraft Township Offices or visit any Secretary of State's office or the County Clerk's office to register to vote.

If you were previously registered in Michigan but have recently moved into the Village - you may change your address on line at [www.michigan.gov/sos/online](http://www.michigan.gov/sos/online) services.

### **Schoolcraft Christmas Walk**

First weekend in December.

Like Schoolcraft Antique Mall and Village of Schoolcraft on Facebook  
For details and updates.

## Village Directory

Administrative Office 269-679-4304  
 Police Department 269-679-5600  
 Department of Public Works 269-679-5658  
 Associated Gov. Services 1-800-627-2801

## Village Council

President: Keith Gunnett  
 Trustees: Russell Barnes  
 Todd Carlin  
 Dorothy J. Clark  
 Michael Rochholz  
 Sy Spears  
 Chris Vargo

Messages for the Village Council can be left at the Administrative Office or on Village Staff email.

## Village Staff

Manager: Cheri Lutz, [cmlutz@villageofschoolcraft.com](mailto:cmlutz@villageofschoolcraft.com)  
 Clerk/  
 Treasurer: Faith Akert, [fakert@villageofschoolcraft.com](mailto:fakert@villageofschoolcraft.com)  
 Office  
 Assistant: Theresa O'Leary, [toleary@villageofschoolcraft.com](mailto:toleary@villageofschoolcraft.com)  
 Police  
 Chief: Bryan Campbell, [bcampbell@villageofschoolcraft.com](mailto:bcampbell@villageofschoolcraft.com)  
 Sergeant: Jamie Edwards  
 Officers: Tim Hulinec  
 Henry Kite  
 Aaron McCullough  
 Eric Ray  
 Jeff Schommer  
 Justin VanderKooy  
 Aux. Officers: Mary Secondi and Kevin Sampson  
 DPW Super: Rob Coffman, [rcoffman@villageofschoolcraft.com](mailto:rcoffman@villageofschoolcraft.com)  
 Equip/Water  
 Operator: Adam Wood, [awood@villageofschoolcraft.com](mailto:awood@villageofschoolcraft.com)

## Village of Schoolcraft Fall 2016 Newsletter



«AccCustomerName»  
 «AccCustomerStreetAddr»  
 «AccCustomerStreetAddr2»  
 «AccCustomer-  
 City»,«AccCustomerState»«AccCustomerZip»

PRESORTED STANDARD  
 ECR  
 US POSTAGE PAID  
 SCHOOLCRAFT MI  
 PERMIT NO. 16

The Village of Schoolcraft  
 P.O. Box 8  
 Schoolcraft, MI 49087  
 Return Service Requested